

5. FAULTS AND REMEDIES CHECK LIST

If there is a leak, it is advisable to replace the gaskets which are near the dripping (see elements no. 2, no. 6 and no. 10, picture 6).

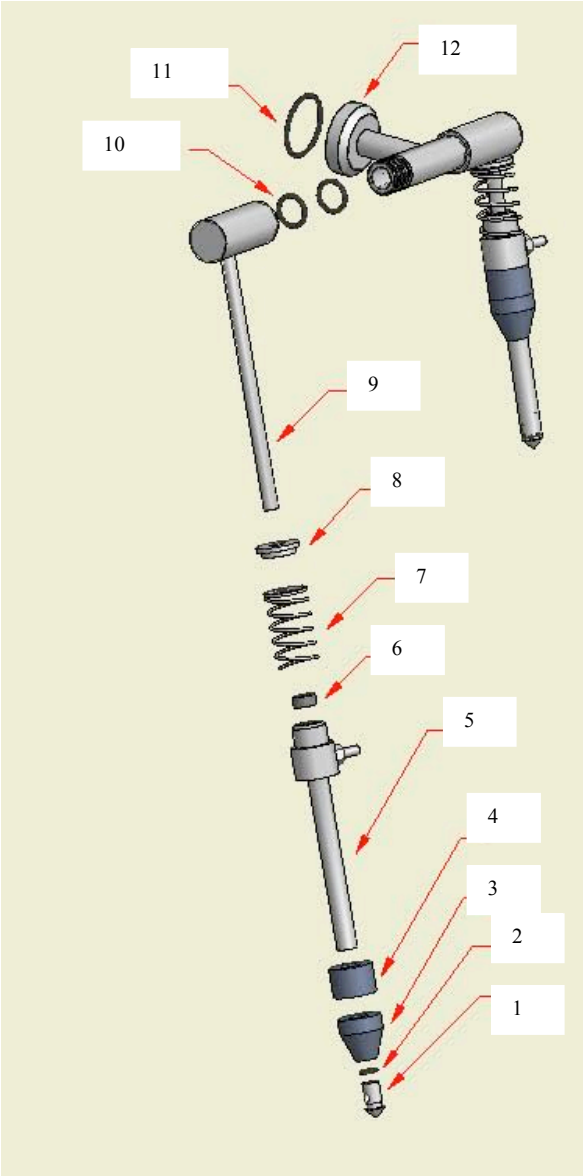

Picture 6.

POSITION	DESCRIPTION	REFERENCE
1	Lower seal element	Rmp0507
2	2037 O-ring	Tap0423
3	Conical seal element	Rmp1005
4	Rubber cone adjusting ring	Rmp0113
5	Sliding pipe	Rmp0504
6	1016/1 Mad Gasket	Tap0426
7	Closing spring of the injector	Rmp0116
8	Upper reference of the spring	Tap0503
9	Main duct	Tap0502
10	2068 O-ring	Tap0424
11	3131 O-ring	Tap0425
12	Double seals horizontal shaft	Rmp1060